



Installation Instructions



PRODUCT: JK REAR TRACK BAR MOUNT KIT

REV: B | 12-08-2014 | II-7012

READ INSTRUCTIONS IN FULL BEFORE INSTALLATION.

QUESTIONS? CALL 916-631-8071 M-F 7:00 AM – 5:00 PM PST

The MetalCloak experience includes the ease of installation of our products. We design for most contingencies, but installation may be different based on different Jeep condition, configuration and/or year.

We are continually trying to improve our products and instructions – please help us by providing feedback and pictures if you find any part of the instructions that do not match your particular Jeep or are not easily understandable.

If you have any difficulties at all, please give us a call. Thank you and enjoy your MetalCloak Products!

IMPORTANT NOTE: We use Stainless Steel Hardware where possible. Therefore, a tube of Silver Anti-seize is provided and should be used on all bolts—only a small amount is needed.

WARRANTY INFORMATION: This article is sold without warranty expressed or implied. No warranty or representation is made as to this products ability to protect the user from injury or death. The user assumes that risk. The effectiveness, warranty and longevity of this equipment are directly related to the manner in which it is INSTALLED, USED and/or MAINTAINED. THE USER ASSUMES ALL RISK. By purchasing this product and opening the packaging, purchasers expressly acknowledge, understand and agree that they take, select and purchase these MetalCloak products from Armored Works, LLC, its affiliates and distributors and agents as is and with all faults. The entire risk as to the quality and performance of these MetalCloak products is with the purchaser. Working on your vehicle can be a dangerous activity. If you are unsure of what you are doing, please leave mechanical or safety critical work to a skilled mechanic. We take no responsibility for the incorrect use and/or installation of MetalCloak products.

Section 1: Tools & Notes on Installation



Tools Required: This list is the recommended tools for ease of installation. Other versions of the same tool can be used. For example, Allen Wrenches instead of Allen Drive Sockets.



Socket & Ratchet Wrench

21mm Socket/Wrench
14mm Socket/Wrench



3/4" Socket/Wrench
13/16" Socket/Wrench
7/8" Socket/Wrench



HOW TO USE THIS GUIDE: The installation guide contains ALL steps for installation. Please read and follow the instructions in order of each page top to bottom, and left to right.

Jeep Model: Instructions may apply to multiple Jeep models, but are labeled separately where appropriate (i.e. TJ vs. LJ).

Options: Because of the number of component options we offer, these instructions may contain steps that will not match your particular configuration. You can skip these steps.

Images: Pictures are provided and parts are labeled throughout the instructions. Each text box contains guidance based on the pictures next to it. The text will refer to alphabetical labels (A, B, etc) found in the images.

Installation Notes: Terms may be used in the body of the instructions that you may not be familiar with, if you have any questions feel free to contact us at the number below, or email techhelp@metalcloak.com

QUESTIONS: Any questions or comments about the instructions? Call us at 916-631-8071 M-F 7:00 AM – 5:00 PM PST.

Section 2: Installation Instructions

Important note: To install lift components you will need to fully 'droop' your suspension in the front and rear (though not at the same time). We strongly recommend that the vehicle be placed on an automotive lift and that all appropriate safety precautions be taken to secure the vehicle while it is off the ground. Always use the necessary axle stands (or equivalent) to support the axle when the suspension components are disconnected for safety, and to ensure the integrity of your suspension system during the installation process.

Step 1: Remove Stock Track Bar

- A. Use a 21mm Socket & Wrench to unbolt the stock hardware, and remove the track bar.
- B. Also remove the stock bolt that secures the driver's side, lower, rear control arm to the axle bracket (*the bracket has been trimmed in this picture*).

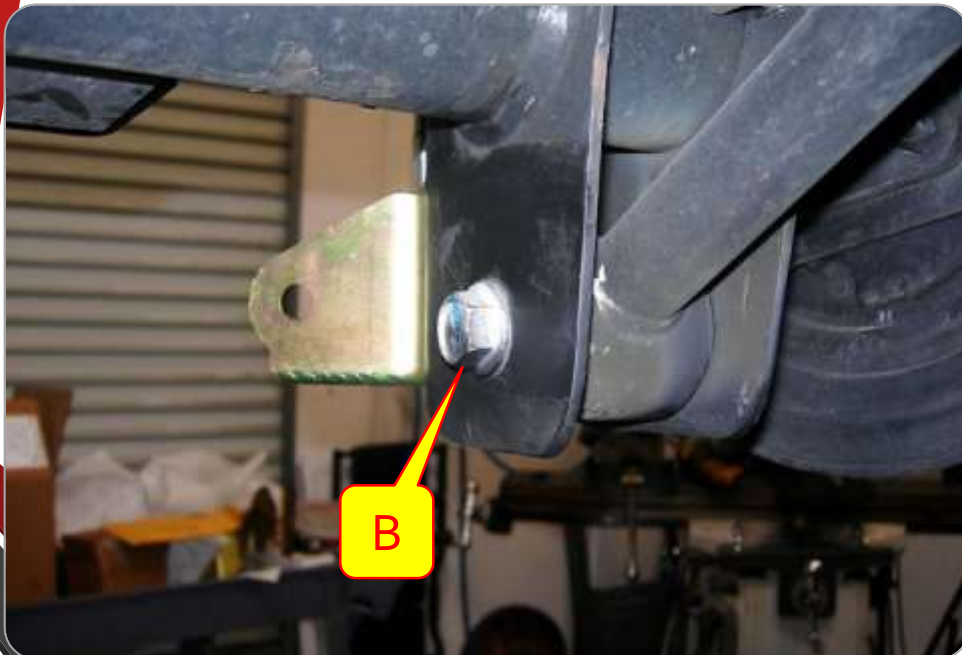

Section 2: Installation Instructions

Step 2: Install MetalCloak Track Bar Bracket (cont'd)

- C. Slide the MetalCloak Track Bar Bracket in place as shown and re-install the stock bolt through the control arm; do not fully tighten any hardware until the Bracket is fully installed.
- D. Insert the provided Spacer in the axle bracket where the stock track bar was mounted.
- E. Install the provided M14-2x100mm" Hex Cap Screw through the stock hole with a Washer under the head of the Screw.
- F. The Screw is backed by a M14" Nylon Jam LockNut and Washer; install but do not fully tighten.
- G. Use a 3/4" Socket to install the 1/2"-20 U-bolt with the provided 1/2"-20 Flange LockNuts. You can snug all the Bracket hardware at this time, but do not fully tighten.
- H. Re-install stock track bar.

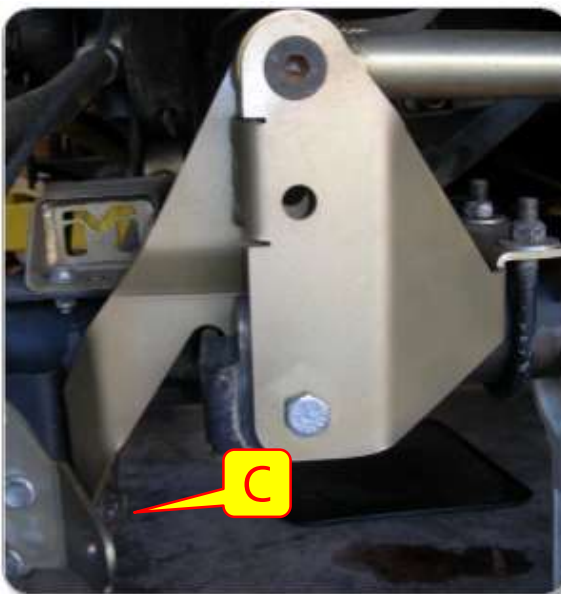

Section 3: Product Components

ITEM	PART NUMBER/DESCRIPTION	QTY.
1	CP-3722 STANDOFF, REAR TRACK BAR, JK	1
2	FA-2025 FLANGE HEX LOCKNUT, 0.5-20 X 1.03FLG ZNC PLTD	2
3	FA-2026 U-BOLT, 0.5-20 X D3.19 X 5.0L, B7 STL ZNC PLT	1
4	FA-2031 CSCS, M14-2 X 70L CLASS 10.9 ZNC PLTD	1
5	FA-2039 CONICAL LOCK NUT, M14-2.0 X 14TH ZNC PLT STL	2
6	FA-2082 HHCSCREW M14-2.0 X 80L CLS 10.9 ZNC PLT STL	1
7	WM-5009 WELDMENT, REAR TRACK BAR BRACKET, JK	1

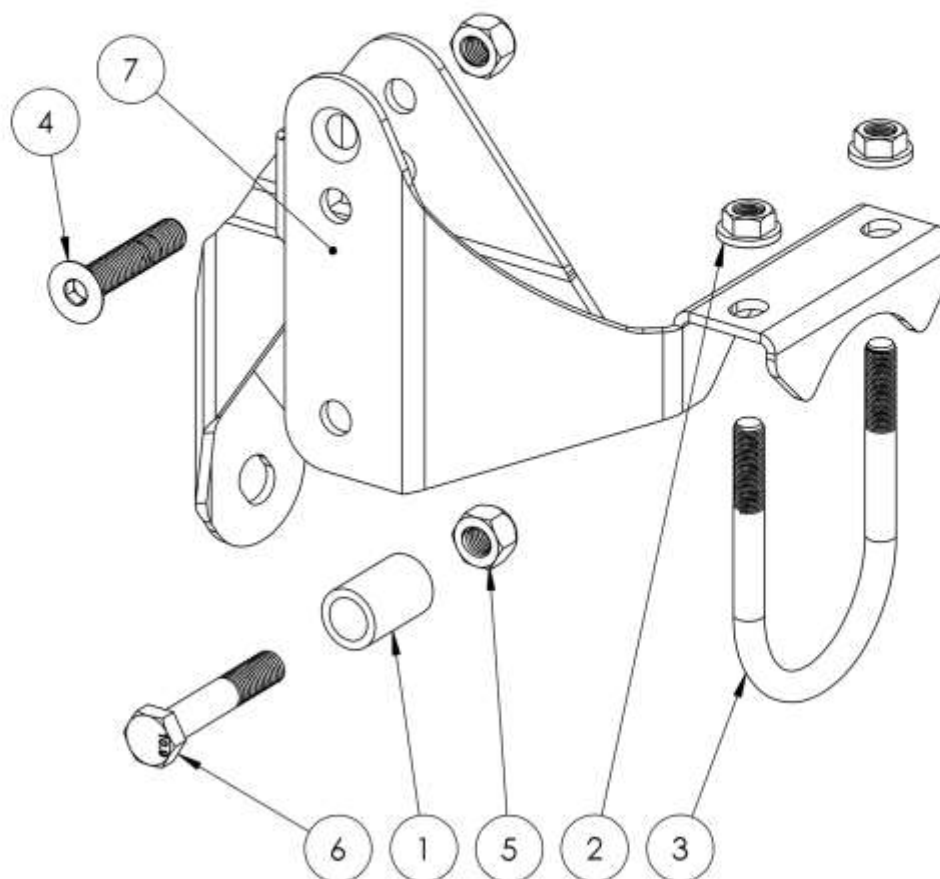

Enjoy Your JK Rear Track Bar Mount!



Remember to post your pic of your Cloaked JEEP on your favorite forum and at [Facebook.com/metalcloak](https://www.facebook.com/metalcloak).

BITE BACK